



GEPLAST
Building

BIOCLIMATIC SLAT

Lame Bioclimatique®
MARQUE & DESIGN DÉPOSÉS

TRADEMARK & DESIGN REGISTERED

ALU



PVC



ITS STRENGTHS

◆ Solar gain management

Control of solar gain with **4 times more light and ventilation** in the home than a standard blade for optimal comfort in summer.

Exceptional visibility toward outside in the open position.

Regular micro-punching diffusing a soft and soothing light within the living rooms.

◆ New functionalities

Safety functions and total opacity in the closed position for optimum sleeping comfort thanks to the development of our rubber seals integrated into our sliders.

Improved acoustic comfort when the curtain rises and falls.

Integrated insect screen and blind functions.

Available in PVC or aluminium.

◆ Easy to implement

Manufacture and installation identical to a standard blade.

Ideal for large widths bay.

Curtain must be tested for vertical rise and fall before installation at the customer's premises.

PERFORMANCES

PVC THERMAL

Rsh = 0,101 m².K/W
Classe 4 : Δr = 0,22 m².K/W
Classe 5 : Δr = 0,27 m².K/W

AÉRAULIC

Safety pressure classes 1.5p (N/m²)
Indicative tests

Width	1000	1200	1400	1600
Height				
2250 mm	V*6	V*5	V*4	V*3
1400 mm	V*6	V*5	V*4	V*3

ALU

Rsh = 0,01 m².K/W
Classe 4 : ΔR = 0,15 m².K/W
Classe 5 : ΔR = 0,18 m².K/W

AÉRAULIC

Safety pressure classes 1.5p (N/m²) - Indicative tests

Width	0 à 2000	2100	2200	2300 à 2400	2500	2600 à 2800	2900	3000
Height								
2250 mm	V*6	V*5	V*5	V*5	V*4	V*4	V*3	V*3
1400 mm	V*6	V*6	V*6	V*5	V*5	V*4	V*4	V*4

LIGHT TRANSMISSION



Normal / hemispheric light transmission factor :
T_v^{nh} = 3% (PV CSTB)

The bioclimatic slat, in the openwork position, is comparable to a awning fabric or ZIP blind in terms of light comfort and provides excellent glare control.

Transmission factor of solar radiation inside the building, roller shutter closed		
Light colours (white, light gri...)	[L* >82]	Sws = 0,05
Dark colours (brown, black, etc.)	[L* <82]	Sws = 0,10

AIR PERMEABILITY



The bioclimatic slat allows an airflow (over-ventilation that allows the air in the house to be cooled):

Qa = 939m³/h per m² of deck (PV CSTB)

CORROSION RESISTANT

New, more corrosion-resistant ALU strip.
Salt spray test (PV CSTB).



NEW ALU BLADE FORMING MACHINE

"We recently invested in an aluminium roller shutter slat profiling machine. This is located in our new 5,000 m² extension, part of which is dedicated exclusively to this new profiling 'business' at Geplast.





This integration has enabled us to acquire new technical skills in-house and to fully control the production of our Bioclimatique® Blade. Made from 99.5% recycled aluminium strip, the Lame Bioclimatique® is part of a "responsible" approach. It enables us to meet the challenges of the RE2020, which now requires the control of ventilation and solar gain within homes".





Maxime Grimault
Sales & Marketing Director

Available colours Bioclimatic slat & final slat

Other colours on request.

ALU COLORIS LAQUÉS 4 NEW COLORS

-  Umber grey | RAL 7022
code : VR040AJ_AL7022
-  Alu natural | RAL 9006
code : VR040AJ_AL9006
-  Grey 2900 sanded
code : VR040AJ_AL2900S
-  Black 9005
code : VR040AJ_AL9005
-  Beige | RAL 1015
code : VR040AJ_AL1015

-  White | RAL 9016
code : VR040AJ_AL9016
-  Dark brown | RAL 8019
code : VR040AJ_AL8019
-  Light grey | RAL 7035
code : VR040AJ_AL7035
-  Black 2100 sanded
code : VR040AJ_AL2100S
-  Anthracite grey | RAL 7016
code : VR040AJ_AL7016

PVC COLORS MASS COLOURED

-  Blanc | RAL 9016
code : VR040AJ_BL012

REFERENCES AND PACK SIZE

Bioclimatic slat

ALU

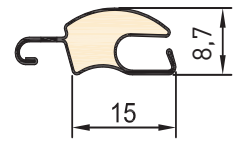

NEW

New 0.30mm strap, made from 99.5% recycled aluminium, more resistant to corrosion
New 115Kg/m³ high-density foam for exceptional rigidity

VR040AJ_AL

Bioclimatic slat ALU openwork roller shutter 15 x 8,7mm
 65 bars of 6 ml / pack or 5 trays of 13 slides

Nominal thickness	8,7 mm
Working height	15 mm
Number of slats / m	67
Weight	5 Kg/m ²
Max width	3 m
Max surface area	7 m ²
Standard length	6 m



PVC

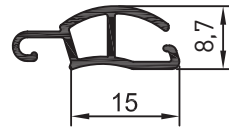

VR040AJ

Bioclimatic slat ALU openwork roller shutter 15 x 8.7 mm
 65 bars of 6 ml / pack or 5 trays of 13 slides
 1950 bars of 6 ml / container or 150 trays of 13 slides

Nominal thickness	8,7 mm
Working height	15 mm
Number of slats / m	67
Weight	5 Kg/m ²
Max width	1,6 m
Max surface area	3 m ²
Standard length	6 m

Final slat

VR081F_AL

Final blade 49 x 8,5 mm
 10 bars of 6 ml / pack



STOCK LACQUERED COLOURS

Gloss white 9016 Satin anthracite 7016

Gross + other colours available, similar to those of Bioclimatique® Blades from 60ml upwards

AC120_N0004
 End blade seal
 200mm roll

COLORS

Black

Installation



FoKus 235 box - Timber frame assembly
 ALU bioclimatic® slat - anthracite grey 7016

WINDING DIAMETERS IN BOXES

	Maximum number of blades	Maximum height under box	Maximum winding Ø
IrYs	164	2450	Ø 200
FoKus 235	180	2700	Ø 200
FoKus 205	130	1950	Ø 180
FoKus 168	90	1350	Ø 145
GVR.e	150	2250	Ø 185
GVR.dL	150	2250	Ø 185
Reno City	100	1500	Ø 170
GVR.r	103	1550	Ø 160

The heights under the box are given as an indication and must be verified by tests in situ at the assembler's.

It is imperative to use the PVC/ALU runners, rubber seals and end slats recommended by GEPLAST, without which GEPLAST declines all responsibility.

Rails and rubber seals

Designed and extruded in ABS and soft PVC for better resistance to heat and shrinkage, our rubber seals can be integrated with Geplast's PVC or ALU guiderails as well as with traditional and renovation guiderails on the market.

With Geplast ALU guiderails :

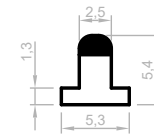

AC101_N0004
 Black rubber seals
 5,3 x 5,4 mm
 50 bars of 6 ml / pack

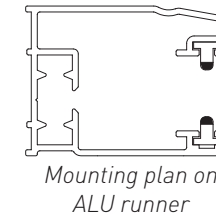

With Geplast PVC guiderails :

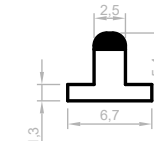

AC102_N0004
 Black rubber seals
 6,7 x 5,4 mm
 50 bars of 6 ml / pack

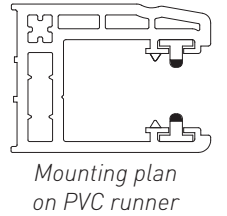

With traditional ALU guiderails and market renovations :

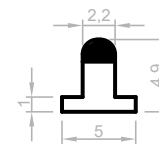

AC100_N0004
 Black rubber seals
 5 x 4,9 mm
 50 bars of 6 ml / pack

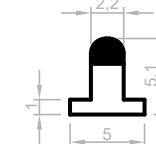

AC103_N0004
 Black rubber seals
 5 x 5,1 mm
 50 bars of 6 ml / pack

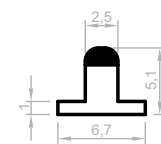

AC117_N0004
 Black rubber seals
 6,7 x 5,1 mm
 50 bars of 6 ml / pack

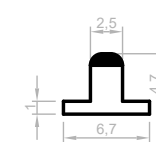

AC118_N0004
 Black rubber seals
 6,7 x 4,7 mm
 50 bars of 6 ml / pack

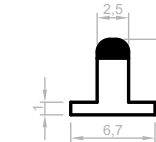

AC119_N0004
 Black rubber seals
 6,7 x 6 mm
 50 bars of 6 ml / pack

ALU



Assembly of the rubber seal on PVC guiderail

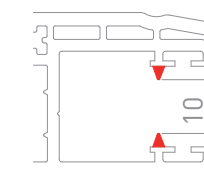

NB : the bioclimatic slat is used with the PVC guiderail and the coextruded joint : **JC10**

In accordance with FFB guidelines, roller shutters, when deployed, can sometimes present a wavy appearance. This phenomenon is accentuated for large products. Find out more about the Quality Assessment Guide for roller shutters, available and downloadable from the websites : www.geplast.fr and www.groupe-actibaie.org.

SPECIFIC MACHINES

Geplast has set up a partnership with manufacturers of machines and roller shutter end caps. These end caps, to be placed at the edges of the slats, offer many advantages :

- ◆ Reduced manufacturing time
- ◆ Easier to roll up the apron
- ◆ Keeping the slats in place against translation
- ◆ Anti-noise and anti-friction clamping system



Manual stapler

Machine for cutting and assembling aluminium roller shutter apron



END CAP FOR 15 MM BIOCLIMATIC SLAT

AC079
10 000 pieces/carton



The end cap is attached to the left and right ends of the PVC and ALU slats. Its role is to stop the horizontal translation of the slats in order to guarantee an optimal operation of the bioclimatic roller shutter.

Automatic stapler

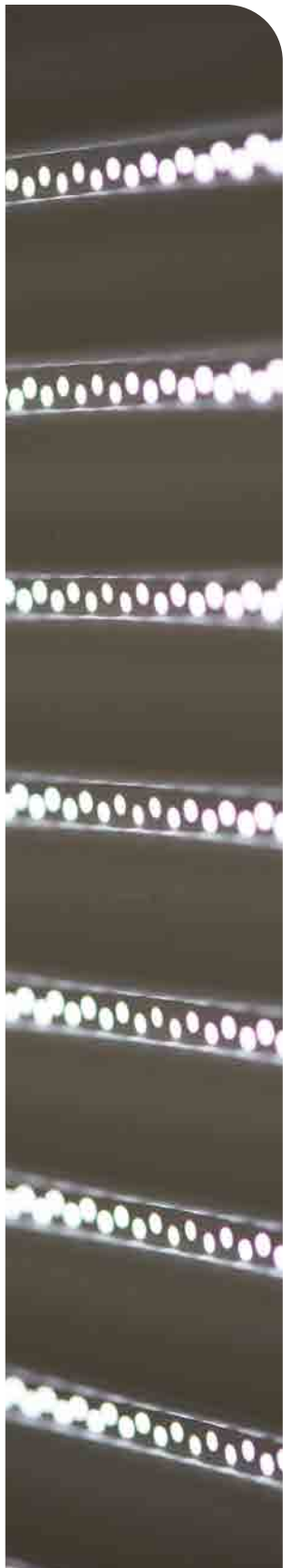

The data contained in this documentation is for information purposes only and only takes into account the wind resistance of the slats manufactured by Geplast in accordance with the test procedures on this subject in the European standard NF EN 13659:2004. Geplast can in no way be held responsible for the manufacture or installation of its products and/or their inappropriate use. Geplast cannot be held responsible for any interpretation of these results without verification by the assembler, taking into account his own manufacturing and/or the imposed installation context. It is the assembler's responsibility to check the compatibility of the boards with DTU 34-2 FD P 25-202 and EN 13659:2004 available from AFNOR and CSTB. The present information does not release the assembler from the duty to carry out the tests requested in the NF EN 1369 standard on his products in order to affix the CE mark.

MADE IN
FRANCE



GEPLAST SAS
Z.I. Actipôle Nord 249
6, rue de Beauséjour
Saint-André-de-la-Marche
49450 SÈVREMOINE
Téléphone : 02.41.49.80.90
Fax : 02.41.46.42.07



GEPLAST

L'avenir se profile ensemble

WWW.GEPLAST.FR

